

JOINSCAN LEDs

S.36A 0.36 INCH (9.15mm) SINGLE DIGIT 14 X 7.5 X 8.5mm

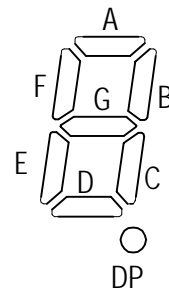
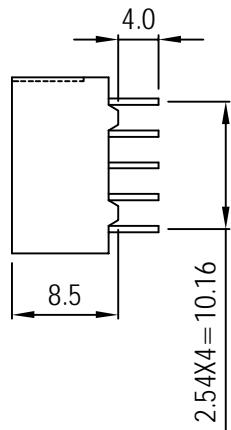
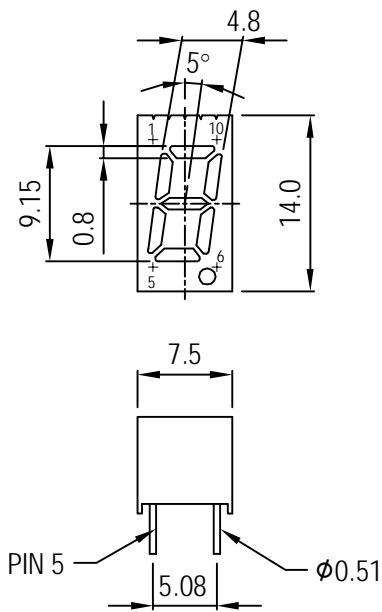

UNIT : mm
TOLERANCE : ±0.2mm

A. A3618 SERIES

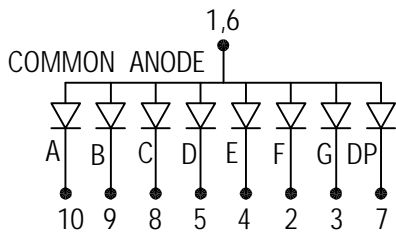

C. A3616 SERIES

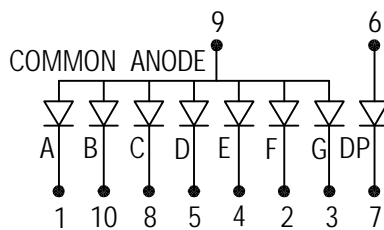

E. A3617 SERIES

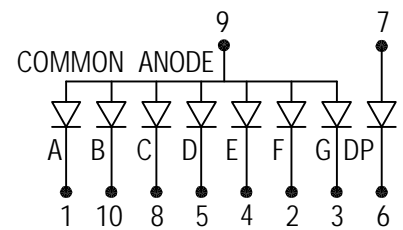

B. C3618 SERIES

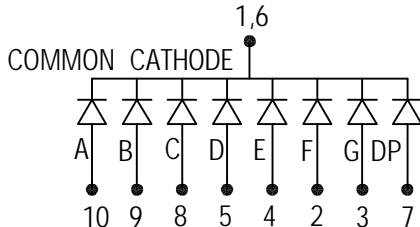

D. C3616 SERIES

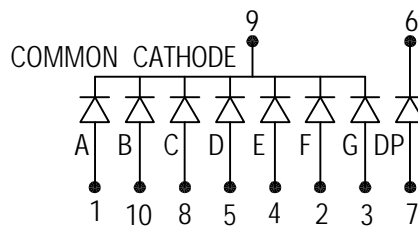

PIN FUNCTION	COMMON ANODE			COMMON CATHODE			WAVE LENGTH (nm)	IR MAX (uA) VR=5V	VF (V) IF=20mA	LUMINOUS INTENSITY IF=20mA
	A	C	E	B	D	F				
GaP RED	A3618H	A3616H	A3617H	C3618H	C3616H		695	100	2.2	0.4mcd
GaAsP ORANGE RED	A3618O	A3616O	A3617O	C3618O	C3616O		630	100	2.0	2.5mcd
GaP GREEN	A3618G	A3616G	A3617G	C3618G	C3616G		570	100	2.2	4.5mcd
Gap Yellow	A3618Y	A3616Y	A3617Y	C3618Y	C3616Y		600	100	2.2	2.5mcd
GaAlAs SUPER RED	A3618RS	A3616RS	A3617RS	C3618RS	C3616RS		650	100	1.8	3.0mcd
GaAlAs ULTRA RED										
GaAlAs YELLOW GREEN										
Sic BLUE	A3618SF	A3616SF	A3617SF	C3618SF	C3616SF		465±5	100	3.6	5.0mcd
ZnSe WHITE										

Model No. -BW BLACK SURFACE WHITE SEGMENT
-BR BLACK SURFACE RED SEGMENT
-GW GRAY SURFACE WHITE SEGMENT

Remark :

1. Typical forward current 10-20mA, MAXimum forward current 25mA
2. Solder Temperature 1.6mm Below Seating plane less 5 seconds at 260°C +5°C -30°C
3. Peak Forward current Per Dice, Duty cycle 1/10, 10KHZ, MAXimum 120mA
4. Operating Temperature From -25°C to 85°C
5. RoHS COMPLIANT

REV : B